



KAIYI



X3 THE REAL ME



INTERPRETATION

X3 - X means infinity, 3 stands for cubic of YI in KAIYI MORE, because we go above and beyond. More represents infinite possibilities, and symbolizes the continuous improvement of X3 in product strength and the continuous exploration of unknown markets.



X3 *FASHION MORE*

New found personality in terms of fashion. The X3 cannot be ignored or overlooked. It's a bold statement of confidence, enhanced by the addition of new front and rear fascia headlights allow us to live life to the fullest on every journey, regardless of where we're going.





EXTERIOR

EXTERIOR

WINGSPAN FRONT INTAKE GRILLE

Express youthful ideals, strong, athletic and without blemish.

TRANSMISSION-TYPE LED HEADLAMP

Lens type LED light source, good concentrating effect, long irradiation range. Effectively increase the safety of driving at night. Three advantages of transmission-type LED light source:

1. Good concentrating effect and long irradiation range (the irradiation distance can reach more than 150m). 2. Low power consumption, less than 0.1W. 3. Long service life, up to 100,000 hours.

LED PULLING-THROUGH TAIL LIGHT

The taillight adopts three-dimensional sculpting design with distinct lines. The contour of the LED lamp belt is prominent, full of stereoscopic feeling. The through-running running lights show a W shape as a whole. The rear bumper has a warped-tail design sighting a higher sense of power and promote the feel of movement.

LED HIGH POSITION STOP LAMP

Wide modeling, higher brightness, lightning speed, can effectively warn and prevent car rear-end and other accidents. Pollution-free, long life (theoretical life of more than 50,000 hours), more energy saving and environmental protection.

SUBSECTION WAIST LINE

The double waistline design of the side wall makes it more rhythmic and dynamic. Rising water cut design, increase the body posture subduction, more dynamic movement; sense of hierarchy and grade.

18" SPORT ALLOY WHEELS

A sporty redesigned exterior with accentuate shiny alloy wheels. It uses 5 pieces of diffusion blade modeling using fine polishing technology, with a strong sense of movement with knife-edge hub plus greater ground grip and smaller flatness to improve vehicle handling.







X3 COMFORT MORE

The interior design of X3 is aimed to meet the needs of young market. The X3 has match steering wheel of luxury vehicle with a modern front panel and center console architecture. It also adopts the enveloping cabin layout to ensure the convenience of the operation of the drivers and passengers inside the vehicle.

INTERIOR

TWO-TONE INTERIOR

Kaiyi X3 adopts two interior color style matching "luxury all black" and "racing red and black". So whether you are formal or sporty the X3 will surely fit your personality.

10.25 INCH HIGH RESOLUTION HD CENTRAL CONTROL SCREEN

Imax8 + 4G hardware platform: 1920x720 resolution that supports 1080P video playback. It also has brightness level of 1000cd/m² which makes reading information clearer in daytime. Close to high contrast of consumer electronics (1000:1) making the image clear and bright. Powered by Android 9.0 System, to reach the level of mobile phone contact and to achieve more touch action.

SHIFT REMINDER

This is convenient according to the current working condition, the trip computer displays the arrow and target gear to remind the user to shift gears reasonably.

LUXURY LEATHER SEAT, DRIVER'S SEAT 6-DIRECTION ELECTRIC ADJUSTMENT

Ergonomic seat design, wide, soft, and comfortable leather strong wrapping. The driver's seat has 6-way electric adjustment and always keep you in the most comfortable state.

7-INCH FULL LCD INSTRUMENT

The LCD Instrument has a full 1280x480 resolution, high image definition, good display effect. Abundant information display: It can display the clock, tire pressure, instantaneous fuel consumption, mileage subtotal, driving range, gear information and others. The visual digital display will surely make the reading more intuitive and convenient.

START STOP BUTTON

Just click to start the vehicle. Save the steps to find the key, more convenient and fast.







*FOR THE MANY ROADS
OF LIFE, ONE X3*

Better exploration of the roads ahead is possible with a vehicle engineered for an improved driving experience. The X3 awakens your spirit of adventure with its increased handling capabilities. Because there's always more to do, more to see, and more to experience—every day no matter where you go.

X3

**FEATURES &
TECHNOLOGY
MORE**

We think that every driver has limitless opportunities to excel and go as far as their driving abilities will allow. See it come to life on the X3, where cutting-edge design and innovation improve your style and abilities. Start your own adventure with your X3.



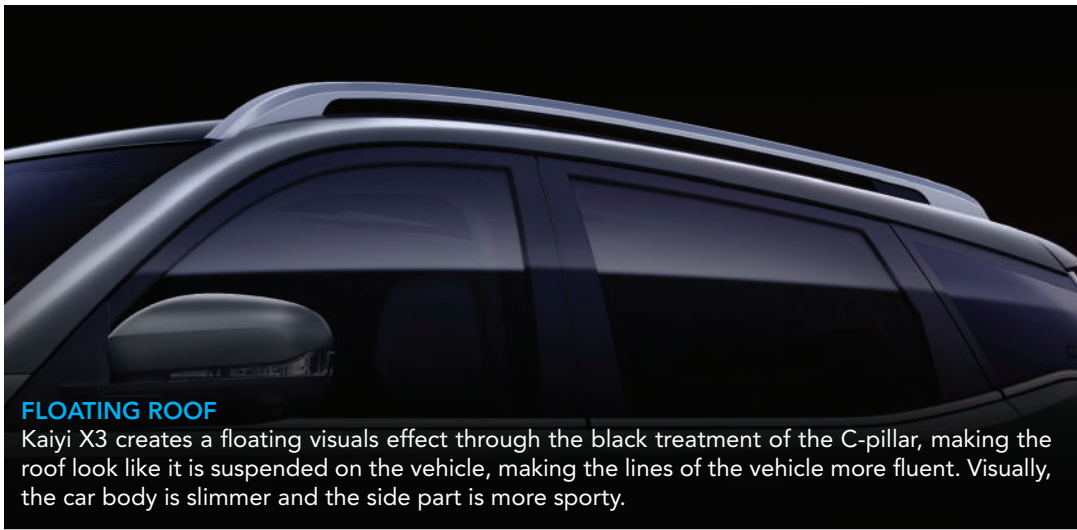

FLOATING ROOF

Kaiyi X3 creates a floating visual effect through the black treatment of the C-pillar, making the roof look like it is suspended on the vehicle, making the lines of the vehicle more fluent. Visually, the car body is slimmer and the side part is more sporty.



LARGE SPACE

The same class long wheelbase, up to 2632mm; Wide and comfortable front and rear space.

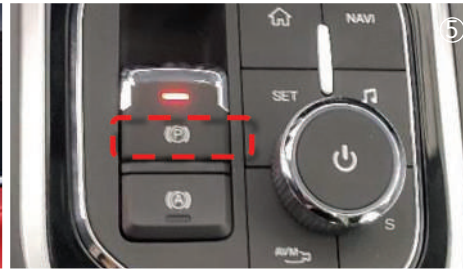

FEATURES & TECHNOLOGY

FEATURES & TECHNOLOGY

CRUISE CONTROL FUNCTION

Simple operation and timely response keeping you safe always; Keep the vehicle running at a constant speed (start when the speed is higher than 40km/h).

AIR OUTLET OF REAR AIR CONDITIONER + DUAL USB SOCKET

Front and back row share the cool and warm, super luxury enjoyment; The whole system is equipped with intelligent control electric air conditioner as standard; Front dual USB ports + rear dual USB ports; Support fast charging of mobile phones.

OUTSIDE REARVIEW MIRROR HEATED

Open and close the rearview mirror with one button, which makes the narrow space more convenient and safer. Electric heating of the lens can effectively prevent water vapor from affecting the sight of the rearview mirror in rainy and snowy weather, and ensure driving safely; The exterior rearview mirror turn signal to remind vehicles and pedestrians in time.

KEYLESS ENTRY

High sensitivity, with the effective range of 1.2m making it easy to lock and unlock

the car; Close to the vehicle, the door automatically unlocks without pressing the key; after getting off the car, it will automatically lock away from the vehicle for a certain distance.

AUTOHOLD + ELECTRONIC HANDBRAKE

The appearance of EPB electronic handbrake, especially the appearance of auto hold, saves the vehicle central control space and greatly improves the practicability; It can reduce the burden of right foot and right hand in traffic jam, and put an end to the inconvenience cause by insufficient strength to pull the handbrake (especially some petite ladies).

MULTI ROAD DRIVING MODE

Two driving modes, sports and energy saving, can be switch at any time.

Normal mode:

Stable output, meet the needs of daily driving, improve fuel economy.

Sport mode:

Mode instant acceleration, throttle response faster, improve driving pleasure.

FLEXIBLE INTERIOR SPACE

Trunk cover curtain increases privacy; The back seat can be folded with one key; 6:4 The split body is put down, and the space is effectively extended giving you more space.



A UNIQUE EXPERIENCE

Every surface, curve, and feature has been carefully considered in order to provide an exceptional driving experience in every way. The new X3 boasts an incredible list of features and conveniences, all of which have been carefully considered for your benefit.

MAXIMUM POWER Kw

85

MAXIMUM TORQUE N.m

143

WHEELBASE mm

2632

X3 *POWER & SAFETY MORE*

You are in command with X3 performance. A powerful 1.5L engine producing 85kW at 6150rpm and 143N.m at 4000rpm. To meet your daily trips, the X3 assures you have a better configuration, higher quality, advanced technology, smoother power-train, and excellent service. T3 is concerned about your safety too. It contains driver-assistive technologies that can assist you in detecting items you might otherwise overlook while driving. They may even be able to help you avoid or lessen the severity of a collision.



①



POWER & SAFETY

POWER & SAFETY

INTEGRATED CAGE BODY

The longitudinal and transverse parts of the car body are connected in a series of rings, just like Taiji. When collision occurs, the impact force is absorbed by the cage body structure, and the passenger compartment will not be damaged, so as to ensure the safety of the people in the car.

BOSCH ESP BODY STABILITY SYSTEM

The adjustment accuracy of Bosch ESP 9.3 on Kaiyi X3 is 33 times higher than that of Bosch ESP 9.1 on most models in the market. The dynamic control of the vehicle body is more delicate, which can effectively improve the acceleration stability and steering stability. It can effectively reduce vehicle skidding, improve the acceleration performance of vehicles on low attached roads such as ice and snow roads, and increase driving safety.

TPMS TIRE PRESSURE MONITORING

Direct tire pressure monitoring, drivers and passengers can timely understand the tire condition through the data feedback of LCD instrument or central control large screen. The data includes the tire pressure and temperature of each tire, so that the driver can take timely measures to ensure the safety of drivers and passengers in case of abnormal tire.

EPS ELECTRIC POWER STEERING SYSTEM

The whole system is equipped with EPS as standard to improved the stability and comfort of vehicle handling. It realizes low inertia, low friction and high efficiency, improves driving comfort and achieves high output. The steering effect is light at low speed and steady at high speed. Compared with hydraulic power, the fuel economy is better.

4 REVERSE PARKING SENSORS

The rear of Kaiyi X3 is equipped with 4-Probe reversing radar, which makes reversing more easy and comfortable.

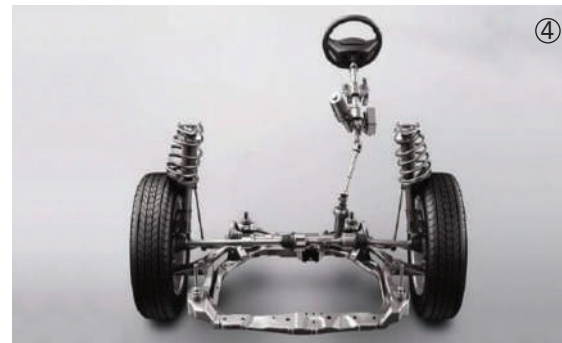

②



③

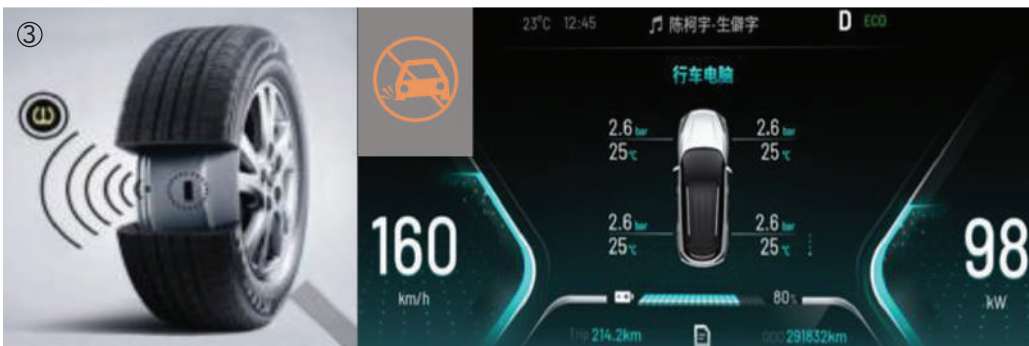

1

2

3

4

5

④

⑤

⑥

6

The maximum monitoring distance is 1.5m. Ultra high sensitivity, timely voice reminder. Progressive sound effect, changing volume and frequency with distance.

DYNAMIC TRACK HD VISUAL REVERSE IMAGE

High definition camera, sensitive response, clear and smooth display effect. Display the reversing track in real time and plan the reversing route intelligently. It also has distance display and reminder function to ensure the safety of reversing.

X3 CONFIGURATIONS

BASIC PARAMETERS

Length * Width * Height (mm)	4400 * 1831 * 1653
Wheelbase (mm)	2632
Minimum Ground Clearance (mm)	158
Body structure	SUV (5 Doors and 5 seats)
Seats number	5
Fuel tank capacity (L)	51

ENGINE

Engine Type	SQRE4G15C
Displacement (ml)	1499
Maximum horsepower (Ps)	116
Maximum power (kW)/Maximum power speed (RPM)	85/6150
Maximum torque (N·m)/Maximum torque speed (RPM)	143/4000
Engine specific technology	DVVT
Emission standard	China VI
Transmission type	5MT

CHASSIS STEERING

Front suspension type/Rear suspension type	Independent MacPherson front suspension /Torsion beam rear suspension
Steering type	Electric power

WHEEL BRAKE

Front brake/Rear brake	Ventilated disc/Disc
Parking brake type	EPB+AUTOHOLD

Note: All the above information is for reference only, please refer to the actual car. All specifications, configuration, body the color, model and other information are subject to change or discontinuation without prior notice.

DIMENSION



INTERIOR



Luxury All Black



Racing Red & Black

WHEELS



17" Alloy Wheels



18" Alloy Wheels





WORLDWIDE MOTORS COMPANY LTD.

HEADQUARTER

No. 79, Russian Blvd (St.110), Sangkat Teuk Thla, Khan Sen Sok, Phnom Penh, Cambodia.

BRANCH 1 - WMC 2004

No.12, St. 6B, Sleng Rolerng Village, Sangkat Teuk Thla, Khan Sensok, Phnom Penh, Cambodia

BRANCH 2 - IMSCG

No. 1AB, St. 29CC, Sangkat Chom Chao, Khan Porsenchey, Phnom Penh, Cambodia

BRANCH 3 - WMP

No. 5A, St. 29CC, Sangkat Chom Chao, Khan Porsenchey, Phnom Penh, Cambodia

CONTACT

+855 78 999 006

+855 93 555 598

+855 12 776 842

✉ info@wmckh.com

🌐 kaiyi.wmckh.com

📘 facebook.com/wmckaiyi

